



6175M-001 OUTDOOR HYDRANT HOSE HOUSE

The WB-6175M-001 Outdoor Hydrant Hose House: used to enclose hydrants as well as store fire-fighting equipment. It is fabricated from 16-gauge galvalume steel with top and bottom ventilation louvers on each side. The spacious double-door walk-in design features an open floor and comes with two sturdy storage shelves. Doors are furnished with (3) heavy-duty butt hinges per door. Product is shipped knocked down with assembly instructions for economical shipping.

FEATURES

Cabinet Material	16 ga. galvalume steel construction
Latch	Chrome plated handle (3-pt), R.H. door
Finish	Polyester Powder Coat Red Paint
Shelves	22 1/2" (57.15 cm) wide x 2" (5.08 cm) x 57 3/4" (146.68 cm) long* 1/2" (12.7 cm) dia hole (6 at back, 3 on each side, 1 in front) <i>IMPORTANT: Specify quantity of shelves & location prior to ordering</i>
Hinges	3 x butt hinges per door
Construction	<ul style="list-style-type: none"> • Top – Solid Roof Protection • Bottom – Open Type • Door Stopper & Roof Support • 2" (5.08cm) wide x 1" (2.54cm) x 3 3/16" (.48cm) channel • Door Reinforcing (all around) • 2" (5.08cm) wide x 1/2" (1.27 cm) deep x 16 ga. channel • Suitable brackets for accessories (optional)
Packaging	Supplied knocked down with assembly instructions
Supplied by Others	<ul style="list-style-type: none"> • Water Hydrant • Cement Base • Anchor Bolt

Model No.	Description	Shipping Weight (lbs)
6175M-001	Outdoor Hydrant Hose House	600 lbs. (empty)

Note:
Not designed for sea water environment.
Contact us for sea water protection options.



6175M-001

DIMENSIONS

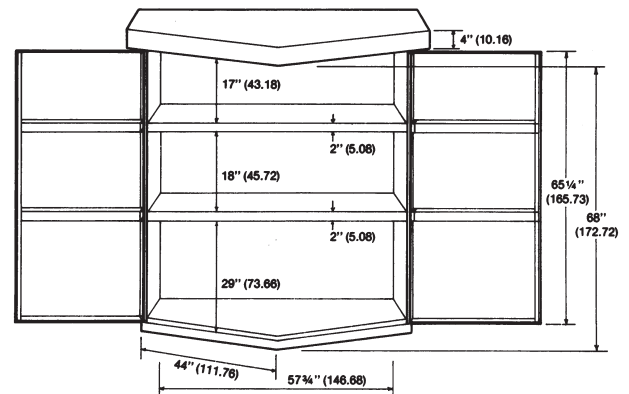

Front View

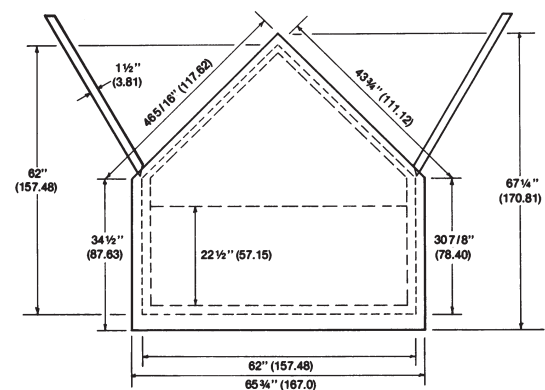

Top View